

# Torit® Backward Inclined Fans

**TBI-3, 5, 7.5, 10, 15, 20 and 30 (60 and 50 Cycle)**

**Torit Backward Inclined (TBI) Fans provide a convenient, cost-effective method of integrating a high efficiency fan with a Donaldson® Torit® dust collector.**

- Mounts directly to the clean-air plenum of the dust collector.
  - Eliminating costly transition ducting
  - Reducing footprint of system
- Sizes range from 3 to 30 hp.
- Backward inclined fan wheel provides high efficiency operation.
- Direct-drive operation eliminates maintenance of fan bearings and belts.
- Computer balanced fan and motor assembly ensures vibration-free operation.
- All necessary hardware for quick and easy installation is included.
- Standard paint finish is blue.



**TBI-15 (60 Cycle)**

## Equipment Options

- Aluminum fan wheel
- Explosion-proof motors - NEMA
- Outlet dampers
- High temperature version available
- Exhaust silencers
- 50 cycle/IEC motor configurations
- Flanges for exhaust ductwork

# Torit Backward Inclined Fans

## Dimensions & Specifications for 60 Cycle TBI Fan

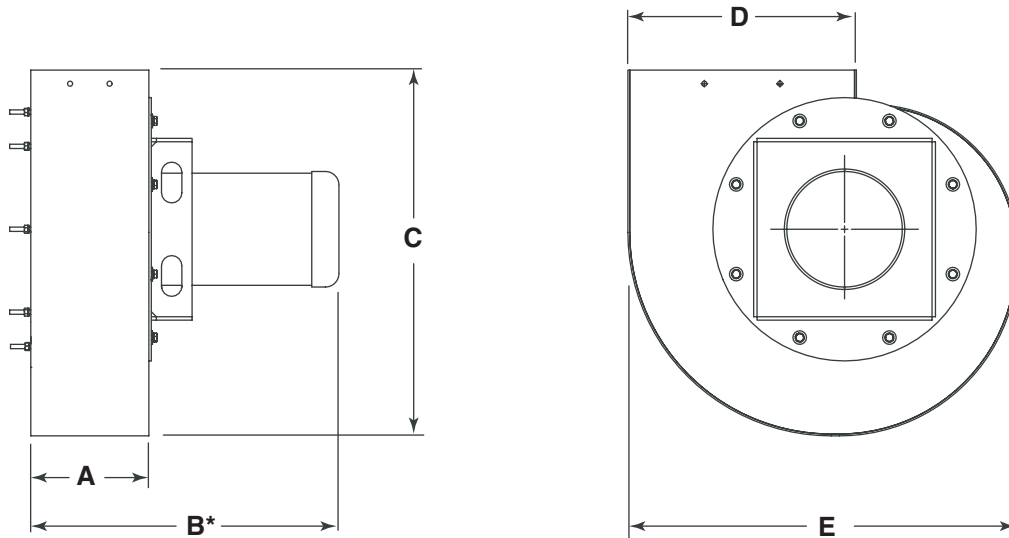

60 Cycle Fans	Dimensions										Shipping Weight	
	A		B*		C		D		E		(lbs)	(kg)
	(in)	(cm)	(in)	(cm)	(in)	(cm)	(in)	(cm)	(in)	(cm)		
<b>TBI-3</b>	7.9	20.1	19.8	50.3	26.9	68.3	16.8	42.7	28.7	72.9	155	70
<b>TBI-5</b>	8.7	22.1	22.7	57.6	26.9	68.3	16.8	42.7	28.7	72.9	178	81
<b>TBI-7.5</b>	10.1	25.6	25.8	65.5	26.9	68.3	16.8	42.7	28.7	72.9	211	96
<b>TBI-10</b>	11.4	28.9	27.1	68.8	26.9	68.3	16.8	42.7	28.7	72.9	242	110
<b>TBI-15</b>	11.9	30.2	28.8	73.2	32.2	81.8	20.4	51.8	34.8	88.4	387	176
<b>TBI-20</b>	13.6	34.4	30.2	76.7	35.5	90.2	20.4	51.8	34.8	88.4	431	196
<b>TBI-30</b>	14.8	37.5	38.4	97.5	37.3	94.7	22.4	56.9	38.3	97.3	640	290

\* This dimension is subject to change based on the motor manufacturer chosen and on the motor enclosure type (TEFC or EP). If this dimension is critical, you should verify the information with your sales representative.

## Performance Curves for 60 Cycle TBI Fan

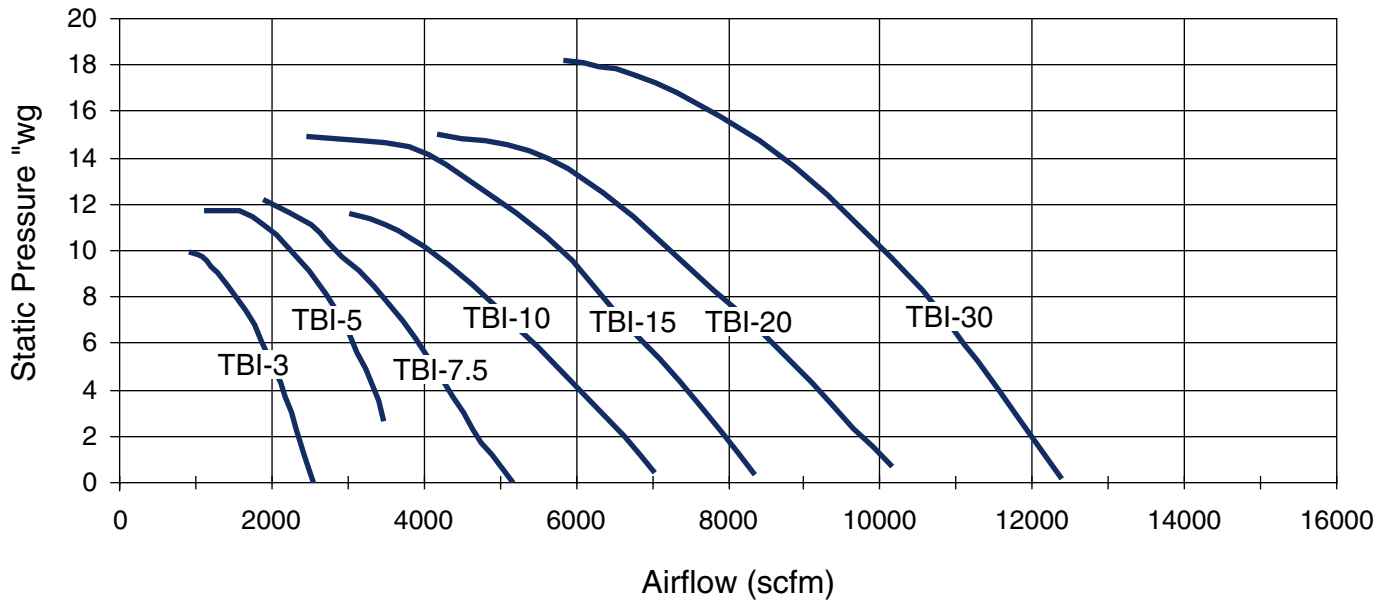

# Torit Backward Inclined Fans

## Dimensions & Specifications for 50 Cycle TBI Fan

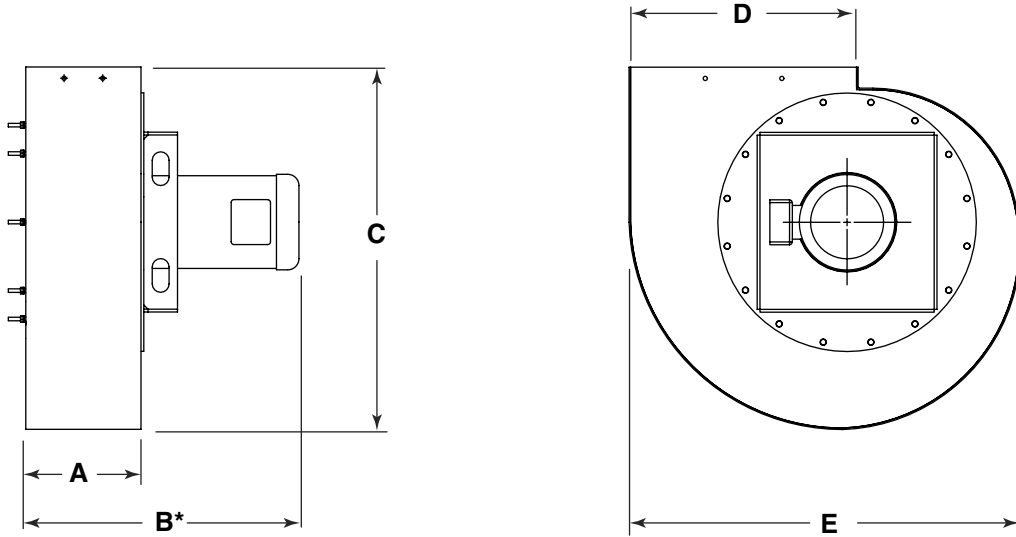

50 Cycle Fans	Dimensions										Shipping Weight	
	A		B*		C		D		E		(lbs)	(kg)
	(in)	(cm)	(in)	(cm)	(in)	(cm)	(in)	(cm)	(in)	(cm)		
TBI-3	8.8	22.5	20.8	52.8	32.2	81.8	20.4	51.8	34.8	88.4	207	94
TBI-5	10.3	26.0	24.3	61.7	32.2	81.8	20.4	51.8	34.8	88.4	233	106
TBI-7.5	11.9	30.2	27.6	70.1	32.2	81.8	20.4	51.8	34.8	88.4	272	123
TBI-10	13.6	34.4	29.3	74.4	32.2	81.8	20.4	51.8	34.8	88.4	303	137
TBI-15	13.9	35.3	30.7	78.0	32.2	81.8	20.4	51.8	34.8	88.4	388	176
TBI-20	15.4	39.2	32.3	82.0	37.4	95.0	22.4	56.9	38.3	97.3	482	219
TBI-30	16.3	41.4	40.0	101.6	40.5	102.9	24.9	63.2	42.5	108.0	683	310

\* This dimension is subject to change based on the motor manufacturer chosen and on the motor enclosure type (TEFC or EP). If this dimension is critical, you should verify the information with your sales representative.

## Performance Curves for 50 Cycle TBI Fan

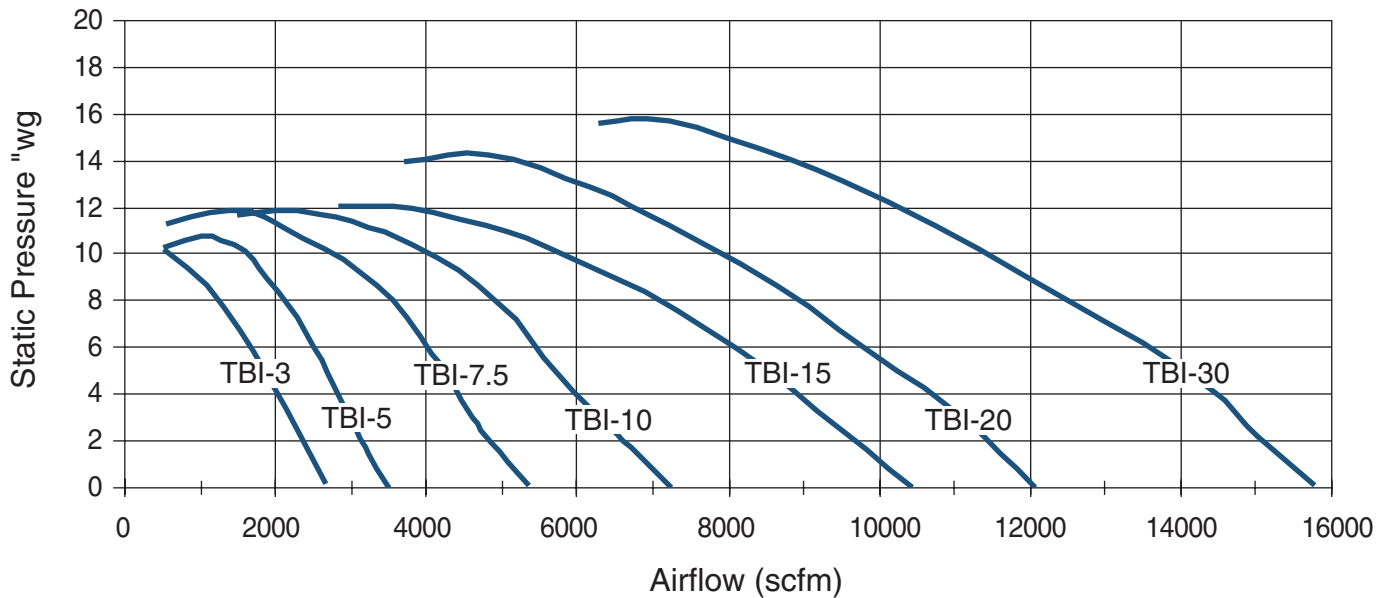

# Torit Backward Inclined Fans

## 60 Cycle TBI Fan Sound Data\*

Model	Overall Assembly Sound <sup>1</sup>
TBI-3	97
TBI-5	99
TBI-7.5	104
TBI-10	100
TBI-15	104
TBI-20	106
TBI-30	107

## 50 Cycle TBI Fan Sound Data\*

Model	Overall Assembly Sound <sup>1</sup>
TBI-3	93
TBI-5	96
TBI-7.5	99
TBI-10	100
TBI-15	103
TBI-20	105
TBI-30	106

\* dB(A) sound levels are an average of measurements made in a laboratory environment. Installed sound levels will vary depending on the measurement location, operating conditions, and installation.

<sup>1</sup> Sound ratings shown are taken at fan peak efficiency at an operating speed of 3500 rpm on the 60 cycle TBI fans and 2920 rpm on the 50 cycle TBI fans. They are the result of laboratory tests based on reverberant room techniques as described in AMCA bulletin 300 and processed by the procedures shown in AMCA 301. The ratings include an open inlet and ducted outlet.



Donaldson Company, Inc.  
Industrial Air Filtration  
P.O. Box 1299  
Minneapolis, MN 55440  
Tel 800-365-1331(USA)  
Tel 800-343-3639 (within Mexico)  
dustmktg@mail.donaldson.com  
www.donaldsontorit.com

Significantly improve the performance of your collector with genuine Donaldson Torit replacement filters and parts.

**Visit us at [www.donaldsondynamic.com](http://www.donaldsondynamic.com)**

Information in this document is subject to change without notice.

© 1994 Donaldson Co., Inc.  
Printed in U.S.A. on recycled paper

Data Sheet TBI Fans (03/05)

